

(TOTAL BOOTH - 488 nos)

**THE STAR EDUCATION FAIR' 2008 @ HALL 01-05, KLCC
(12 - 13 JANUARY 2008)**



KIOSK 02

B
LOADING BAY 2

UTILITY 2

B007	B008	B021	B022	B035	B036	B049	B050	B063	B064	B077	B078	B091	B092	B105	B106	B119	B120
B006	B009	B020	B023	B034	B037	B048	B051	B062	B065	B076	B079	B090	B093	B104	B107	B118	B121
B005	B010	B019	B024	B033	B038	B047	B052	B061	B066	B075	B080	B089	B094	B103	B108	B117	B122
B004	B011	B018	B025	B032	B039	B046	B053	B060	B067	B074	B081	B088	B095	B102	B109	B116	B123
B003	B012	B017	B026	B031	B040	B045	B054	B059	B068	B073	B082	B087	B096	B101	B110	B115	B124
B002	B013	B016	B027	B030	B041	B044	B055	B058	B069	B072	B083	B086	B097	B100	B111	B114	B125
B001	B014	B015	B028	B029	B042	B043	B056	B057	B070	B071	B084	B085	B098	B099	B112	B113	B126

EXHIBITION HALL 2 (126 Booths)

FEMALE

REGISTRATION
INFORMATION

EXHIBITOR
SERVICE DESK

EXHIBITION CONCOURSE



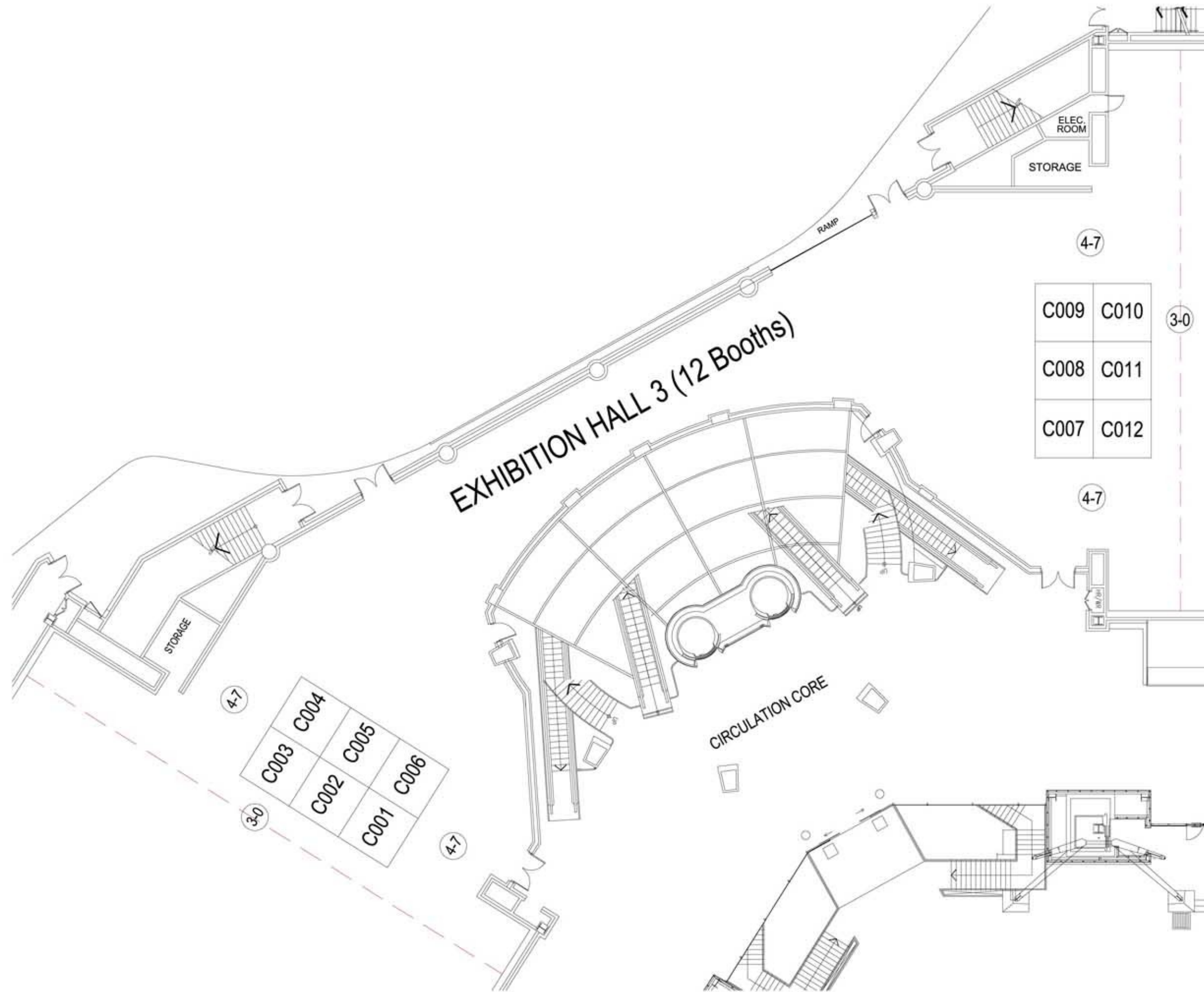

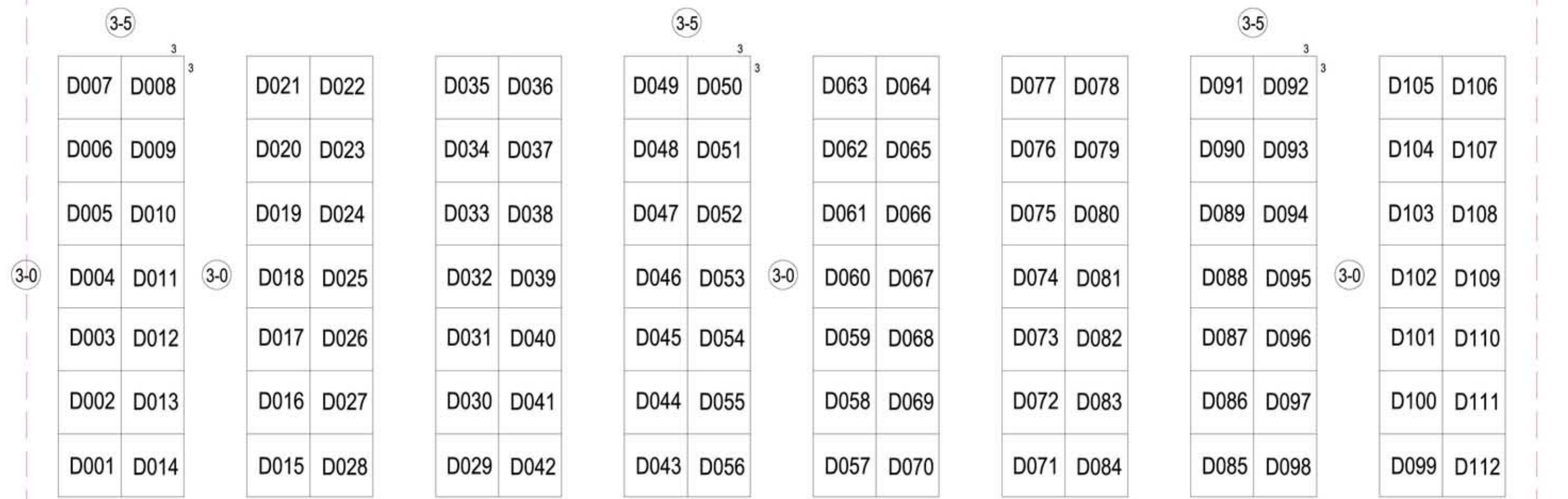
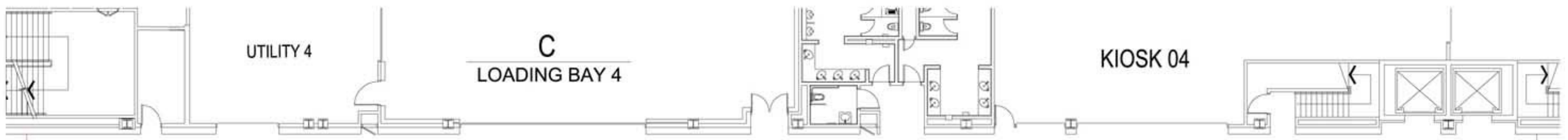

EXHIBITION HALL 4 (112 Booths)

